

The Architects Office

Wehner, Nowysz, Pottschull and Pfiffner
201 day building, iowa city, iowa 52240

DAVENPORT COMMUNITY DEVELOPMENT DEPARTMENT
IOWA DIVISION OF HISTORIC PRESERVATION

SITE # 82-10- MA-1208 MAP # 3

HIST. DIST. College Square

NAME J. Monroe Parker Residence (Ficke) (H) C

ADDRESS 1208 Main Street

LEGAL DES. Allen's 2nd Add. 10 Lots 1, 2 and 3
SUB-DIVISION BLOCK PARCEL SUB-PARCEL

UTM 15 71021240 46100460 ACREAGE 1 ZONE R-6M
EASTING NORTHING

OWNER Delta Sigma Chi Fraternity
1208 Main St., Davenport, IA 52803

TITLE H. De. L. Spain & Wife
(IF DIFF)

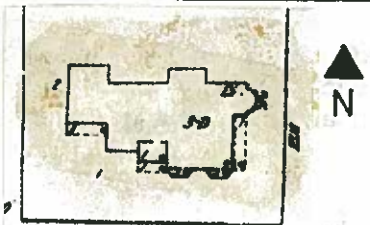

SITE SHEET

DESCRIPTION

FORM 2 stories, irregular plan CONST. DATE 1881
MATERIALS Stone, brick, wood, cast & wrought iron ARCH STYLE Second Empire
FENESTRATION Rectangular 1/1 D.H.S. in broad surrounds w/incised heads
DIST. FEATURES: stone mansard w/iron cresting, bracketted cornice w/paneled frieze, 2-story polygonal window bays, columned porches
ALTERATIONS 1 or 2 porch columns missing; converted to fraternity/apartment building
SITE & RELATED STR. Corner lot north of Sheldon Hall & high school

ARCHITECTURE

STATEMENT

The Ficke House is perhaps the finest example of Second Empire architecture in Iowa, rivalled only by Terrace Hill in Des Moines. From the extraordinary roofscape - crested, dormered, sheathed in polychrome shingles - to the richly detailed cornices, porches and window surrounds, the Ficke House is the ultimate expression of Victorian excess, beautifully composed and finely-executed.

SOURCES

Davenport Democrat & Leader, 30, May, 1904.
HABS Inventory Form, Iowa Division of Historic Preservation

SIGNIFICANCE

This building is associated with a moderately important local political leader and elected official, C.A. Ficke. As an active German-American politician, his career typified the change from Republican party to Democrat party evidenced in the German electorate between 1860 and 1885. Since City Hall remains extant, the value of this property is diminished.

Architect and contractor for the house was T. W. McClelland and Co., with the slate roof by Victor Huot. The design may possibly be credited to Benjamin W. Gartside, who was architect with the McClelland firm from 1878 until becoming vice-president in 1889.

DESCRIPTION

Charles August Ficke came to Davenport as a child in 1851. He became established as a lawyer in 1877 following reading in H.R. Claussen's office and formal study. A successful attorney, Ficke was also active in real estate and several local banks. In 1880, Ficke changed from Republican to Democrat, over such issues as prohibition and women's suffrage. He was elected County Attorney in 1886 and mayor in 1890 & 91. His second election was the largest majority registered by a mayor to date. His administration as mayor was marked by improved paving and sewer construction. His career typified the successful professional and business career of many local German-Americans.

SOURCES

- Downer, Harry, History of Davenport and Scott County, Iowa, Vol. II, Chicago: S.J. Clarke Publishing Company, 1910.
- Johnson, H.B., "German Forty-Eighters in Davenport," Iowa Journal of History and Politics, January, 1946, pp. 3-53.
- Oszuscik, Philippe, A History of the Architecture and Urbanization of Nineteenth Century Davenport, Iowa. Ph.D. Dissertation, University of Iowa, 1979, pp. 378, 387.

ARCHITECTURAL HISTORIAN: Martha Bowers | HISTORIAN: MARLYS SVENDSEN-ROESLER | SURVEY COMP 1981

EVALUATION

ARCHITECTURAL

- I. ARCH. EVALUATION Exceptional
- II. ENVIR. STATURE Landmark
- III. INT. OF CONTEXT Good
- IV. INT. OF FABRIC Excellent

LEVEL OF SIGNIFICANCE:
 NAT. STATE LOCAL N. ELIG.

HISTORICAL

- I. THEME(S) OF SIGNIFICANCE:
A. PRIMARY Gov't. & Politics
B. SECONDARY _____

II. LEVEL OF SIGNIFICANCE:
 NAT. STATE LOCAL

III. NRHP:
ELIGIBLE NOT ELIGIBLE

HISTORIC DISTRICT CLASSIFICATION

A. B. C.

FOR DIVISION OF HISTORIC PRESERVATION USE ONLY

1. DATE RECEIVED _____

2. DATE OF STAFF EVALUATION _____

| | | |
|-----------------------|--------------------------|--------------------------|
| | A. ARCHITECTURAL | B. HISTORICAL |
| ELIGIBLE FOR NRHP | <input type="checkbox"/> | <input type="checkbox"/> |
| NOT ELIGIBLE FOR NRHP | <input type="checkbox"/> | <input type="checkbox"/> |

3. NRHP ACTION

| | | | | |
|-----------------------|-------------------------------|----------------------------------|---------------------------------|------------|
| A. STATE REVIEW COMM. | APP. <input type="checkbox"/> | DISAPP. <input type="checkbox"/> | TABLED <input type="checkbox"/> | DATE _____ |
| B. FEDERAL REVIEW | APP. <input type="checkbox"/> | DISAPP. <input type="checkbox"/> | TABLED <input type="checkbox"/> | DATE _____ |

4. D.H.P. SOURCES

| | |
|---|--|
| <input type="checkbox"/> COUNTY RESOURCES | <input type="checkbox"/> DET. OF ELIGIBILITY |
| <input type="checkbox"/> W'SHIELD SURVEY | <input type="checkbox"/> R. & C. _____ |
| <input checked="" type="checkbox"/> NRHP 11/16/83 | <input checked="" type="checkbox"/> DAVENPORT A/H SURVEY |
| <input type="checkbox"/> GRANT _____ | <input type="checkbox"/> _____ |

5. SUBJECT TRACES _____

6. PHOTO
1620-2,3,4, & 5

The Architects Office

Wehner, Nowysz, Pattschull and Pfiffner
201 oev building, iowa city, iowa 52240

DAVENPORT COMMUNITY DEVELOPMENT DEPARTMENT
IOWA DIVISION OF HISTORIC PRESERVATION

82 - 10 - MA-1208

ADDITIONAL PHOTOGRAPHS:



CONTINUATION